

DIMENSIONS / 尺寸

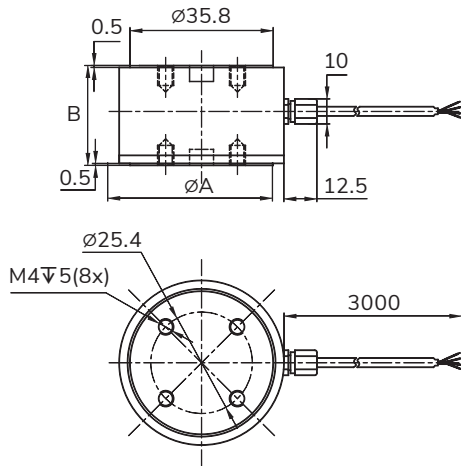

CAPACITIES / 量程

CAP (Kg)	SIZE (mm)	∅A	B
10/20/50/100/200/500		41.2	25

FEATURES & APPLICATIONS / 特点和用途

- For In Line Use In Both Tension And Compression
- Low Deflection
- Fast Response Time
- Superior Natural Frequency
- Small Profile For Tight Spaces
- Suitable For Tension And Compression Situations Of Various Pressure-Holding Equipment

SPECIFICATIONS 详细描述 TECHNIQUE / 技术指标

PERFORMANCE	产品性能	
Non-Linearity	非线性	±0.1% of RO
Hysteresis	滞后	±0.1% of RO
Repeatability	重复性	±0.1% of RO
Creep (30min)	蠕变	±0.05% of RO
Zero Balance	零点输出	±2% of RO
ELECTRICAL	电气特性	
Rated Output	输出灵敏度	2.0 ± 1% mV/V
Recommended Excitation	激励电压	5 ~ 10 VDC
Insulation	绝缘电阻	≥5000 MΩ / 100 VDC
Cable Color Code	连接方式	Input/输入: Red / 红 (E+) Black / 黑 (E-) Output/输出: Green / 绿 (S+) White / 白 (S-)
MECHANICAL	机械特性	
Weight	产品重量	0.2Kg
Safe Overload	安全超载	150% of RO
Ultimate Overload	极限超载	200% of RO
Material	材料	Stainless Steel / 不锈钢
Cable Size	电缆线尺寸	∅3 x 3000 mm
IP Rating	防护等级	IP54
TEMPERATURE	温度特性	
Operating Temperature	工作温度范围	-30 ~ 70°C
Temp. Effect On Output	温度灵敏度漂移	±0.5% of RO / 10°C
Temp. Effect On Zero	零点温度漂移	±0.5% of RO / 10°C
CONFORMITY	遵循	
RoHS		2011/65/EU
CE		2014/35/EU

- 拉压双向传感器
- 低挠度
- 快速响应
- 自然频率优越
- 体积小
- 适用于各种拉压的保压设备

LOAD DIRECTION / 受力方向

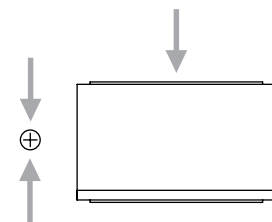

SCHEMATIC WIRING DIAGRAM / 接线图

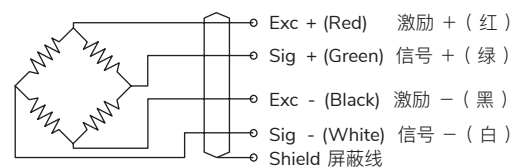

Note: Cable shield is not connected to element.
注：屏蔽线不与弹性体相连。