

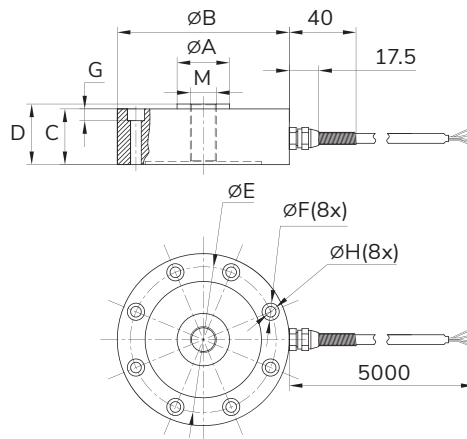

DIMENSIONS / 尺寸



FEATURES & APPLICATIONS / 特点和用途

- Available In Both Tension And Compression
- Low Profile Design
- Highly Resistant To Off-Axis Loading
- Mainly Used For Scales And Other Measuring Devices

CAPACITIES / 量程

CAP (t)	SIZE (mm)	$\varnothing A$	$\varnothing B$	C	D	E	F	G	H	M	Weight / 重量
0.5/1/2/5/7		32	105	34	37	89	10.5	7.2	6.5	M16x1.5	1.8Kg
10/20/25		39	125	46	56	101.8	18	11	10.5	M30x1.5	4.5Kg
30/40/50		60	145	54	65	116.8	20	14	12.5	M40x1.5	7.0Kg

- 拉压双向传感器
- 高度低
- 高度抗离轴负荷
- 主要用于秤和其他测量设备

SPECIFICATIONS 详细描述

TECHNIQUE / 技术指标

PERFORMANCE	产品性能	
Non-Linearity	非线性	$\pm 0.05\%$ of RO
Hysteresis	滞后	$\pm 0.05\%$ of RO
Repeatability	重复性	$\pm 0.03\%$ of RO
Creep (30min)	蠕变	$\pm 0.05\%$ of RO
Zero Balance	零点输出	$\pm 1\%$ of RO
ELECTRICAL	电气特性	
Rated Output	输出灵敏度	$2.0 \pm 1\%$ mV/V
Recommended Excitation	激励电压	10 VDC
Maximum Excitation	最大激励电压	15 VDC
Input Impedance	输入电阻	$750 \pm 10 \Omega$
Output Impedance	输出电阻	$700 \pm 5 \Omega$
Insulation	绝缘电阻	$\geq 5000 \text{ M}\Omega / 100 \text{ VDC}$
Cable Color Code	连接方式	Input/输入: Red / 红 (E+) Black / 黑 (E-) Output/输出: Green / 绿 (S+) White / 白 (S-)
MECHANICAL	机械特性	
Weight	产品重量	See Table Above / 请参考上述表格
Safe Overload	安全超载	150% of RO
Ultimate Overload	极限超载	200% of RO
Material	材料	Alloy steel / 合金钢
Cable Size	电缆线尺寸	$\varnothing 5 \times 5000 \text{ mm}$
IP Rating	防护等级	IP66
TEMPERATURE	温度特性	
Operating Temperature	工作温度范围	$-20 \sim 80^\circ\text{C}$
Compensated Temp. Range	温度补偿范围	$-10 \sim 60^\circ\text{C}$
Temp. Effect On Output	温度灵敏度漂移	$\pm 0.03\%$ of RO / 10°C
Temp. Effect On Zero	零点温度漂移	$\pm 0.03\%$ of RO / 10°C
CONFORMITY	遵循	
RoHS		2011/65/EU
CE		2014/35/EU

LOAD DIRECTION / 受力方向

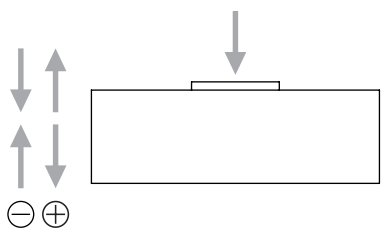

SCHEMATIC WIRING DIAGRAM / 接线图

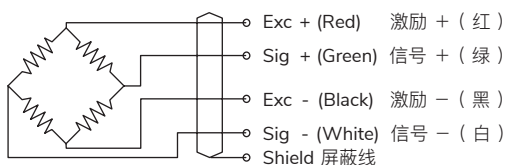

Note: Cable shield is not connected to element.
注：屏蔽线不与弹性体相连。