

## DIMENSIONS / 尺寸

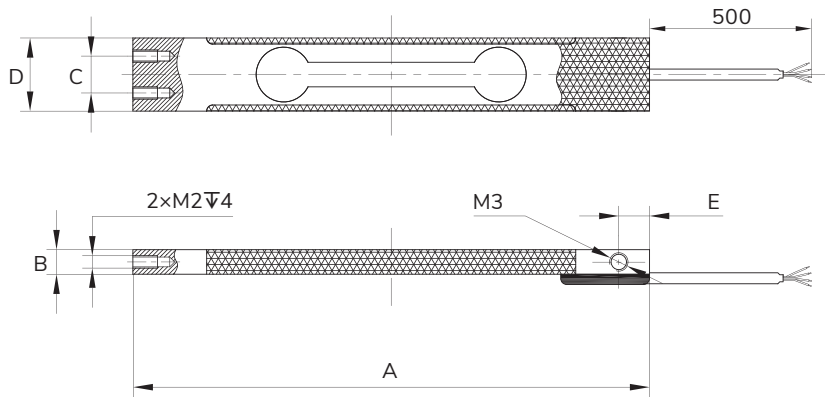

## CAPACITIES / 量程

CAP (g)	SIZE (mm)	A	B	C	D	E
50/100/200		84	4	11.9	6	5

## SPECIFICATIONS

详细描述

TECHNIQUE / 技术指标

PERFORMANCE	产品性能	
Non-Linearity	非线性	±0.01% of RO
Hysteresis	滞后	±0.01% of RO
Repeatability	重复性	±0.01% of RO
Creep (30min)	蠕变	±0.05% of RO
Zero Balance	零点输出	±0.04 mV/V
ELECTRICAL	电气特性	
Rated Output	输出灵敏度	0.7 ± 0.1 mV/V
Recommended Excitation	激励电压	5 VDC
Maximum Excitation	最大激励电压	10 VDC
Input Impedance	输入电阻	1050 ± 20 Ω
Output Impedance	输出电阻	1000 ± 10 Ω
Insulation	绝缘电阻	≥5000 MΩ / 100 VDC
Cable Color Code	连接方式	Input/输入: Red / 红 (E+) Black / 黑 (E-) Output/输出: Green / 绿 (S+) White / 白 (S-)
MECHANICAL	机械特性	
Weight	重量	0.05Kg
Safe Overload	安全超载	500% of RO
Ultimate Overload	极限超载	1000% of RO
Material	材料	Aluminium Alloy / 铝合金
Cable Size	电缆线尺寸	∅0.7 x 500 mm
IP Rating	防护等级	IP64
TEMPERATURE	温度特性	
Operating Temperature	工作温度范围	-20 ~ 80°C
Compensated Temp. Range	温度补偿范围	-10 ~ 40°C
Temp. Effect On Output	温度灵敏度漂移	±0.02% of RO / 10°C
Temp. Effect On Zero	零点温度漂移	±0.02% of RO / 10°C
CONFORMITY	遵循	
RoHS		2011/65/EU
CE		2014/35/EU

## FEATURES &amp; APPLICATIONS / 特点和用途

- Single Point Load Cell
- Exposed Elements
- Light Weight
- Surface Anodized
- Suitable For Measurement Of Force Or Ultra-Small Weighing Occasions

- 单点式传感器
- 可外露使用
- 重量轻
- 表面阳极氧化
- 适用于超小型称重计量场所

## LOAD DIRECTION / 受力方向

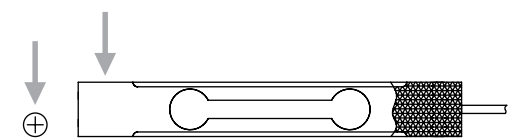

## SCHEMATIC WIRING DIAGRAM / 接线图

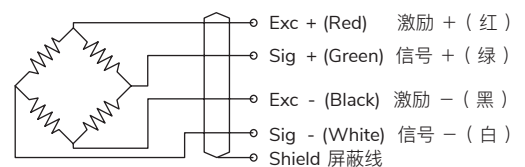

**Note:** Cable shield is not connected to element.  
注：屏蔽线不与弹性体相连。